

SENSITIVE AREA PRE-SCREENING SITE ASSESSMENT

Clean Water Services File Number

1. Jurisdiction: _____

2. Property Information (example: 1S234AB01400)

Tax lot ID(s): _____

OR Site Address: _____

City, State, Zip: _____
Nearest cross street: _____

3. Owner Information

Name: _____
Company: _____
Address: _____
City, State, Zip: _____
Phone/fax: _____
Email: _____

4. Development Activity (check **all** that apply)

- Addition to single family residence (rooms, deck, garage)
 Lot line adjustment Minor land partition
 Residential condominium Commercial condominium
 Residential subdivision Commercial subdivision
 Single lot commercial Multi lot commercial
Other _____

4. Applicant Information

Name: _____
Company: _____
Address: _____
City, State, Zip: _____
Phone/fax: _____
Email: _____

6. Will the project involve any off-site work? Yes No Unknown

Location and description of off-site work: _____

7. Additional comments or information that may be needed to understand your project: _____

This application does NOT replace Grading and Erosion Control Permits, Connection Permits, Building Permits, Site Development Permits, DEQ 1200-C Permit or other permits as issued by the Department of Environmental Quality, Department of State Lands and/or Department of the Army COE. All required permits and approvals must be obtained and completed under applicable local, state, and federal law.

By signing this form, the Owner or Owner's authorized agent or representative, acknowledges and agrees that employees of Clean Water Services have authority to enter the project site at all reasonable times for the purpose of inspecting project site conditions and gathering information related to the project site. I certify that I am familiar with the information contained in this document, and to the best of my knowledge and belief, this information is true, complete, and accurate.

Print/type name _____

Print/type title _____

Signature ONLINE SUBMITTAL _____

Date _____

FOR DISTRICT USE ONLY

- Sensitive areas potentially exist on site or within 200' of the site. **THE APPLICANT MUST PERFORM A SITE ASSESSMENT PRIOR TO ISSUANCE OF A SERVICE PROVIDER LETTER.** If Sensitive Areas exist on the site or within 200 feet on adjacent properties, a Natural Resources Assessment Report may also be required.
- Based on review of the submitted materials and best available information sensitive areas do not appear to exist on site or within 200' of the site. This Sensitive Area Pre-Screening Site Assessment does NOT eliminate the need to evaluate and protect water quality sensitive areas if they are subsequently discovered. This document will serve as your Service Provider Letter as required by Resolution and Order 19-5, Section 3.02.1, as amended by Resolution and Order 19-22. All required permits and approvals must be obtained and completed under applicable local, State and federal law.
- Based on review of the submitted materials and best available information the above referenced project will not significantly impact the existing or potentially sensitive area(s) found near the site. This Sensitive Area Pre-Screening Site Assessment does NOT eliminate the need to evaluate and protect additional water quality sensitive areas if they are subsequently discovered. This document will serve as your Service Provider Letter as required by Resolution and Order 19-5, Section 3.02.1, as amended by Resolution and Order 19-22. All required permits and approvals must be obtained and completed under applicable local, state and federal law.
- THIS SERVICE PROVIDER LETTER IS NOT VALID UNLESS _____ CWS APPROVED SITE PLAN(S) ARE ATTACHED.**
- The proposed activity does not meet the definition of development or the lot was platted after 9/9/95 ORS 92.040(2). **NO SITE ASSESSMENT OR SERVICE PROVIDER LETTER IS REQUIRED.**

Reviewed by Chealsey Rosebrook _____

Date _____

Once complete, email to: SPLReview@cleanwaterservices.org • Fax: (503) 681-4439

OR mail to: SPL Review, Clean Water Services, 2550 SW Hillsboro Highway, Hillsboro, Oregon 97123

STAMP

**FOR
INFORMATION
ONLY**

Drawn By: JG
Checked: JG/MK
Project #: 23.004
Date: 04/28/2023

Rev. # _____ Date _____
_____ dd/mm/yy _____

50%
PRELIMINARY
DESIGN

SHEET TITLE

OVERALL
SITE PLAN

SHEET #

L1.0

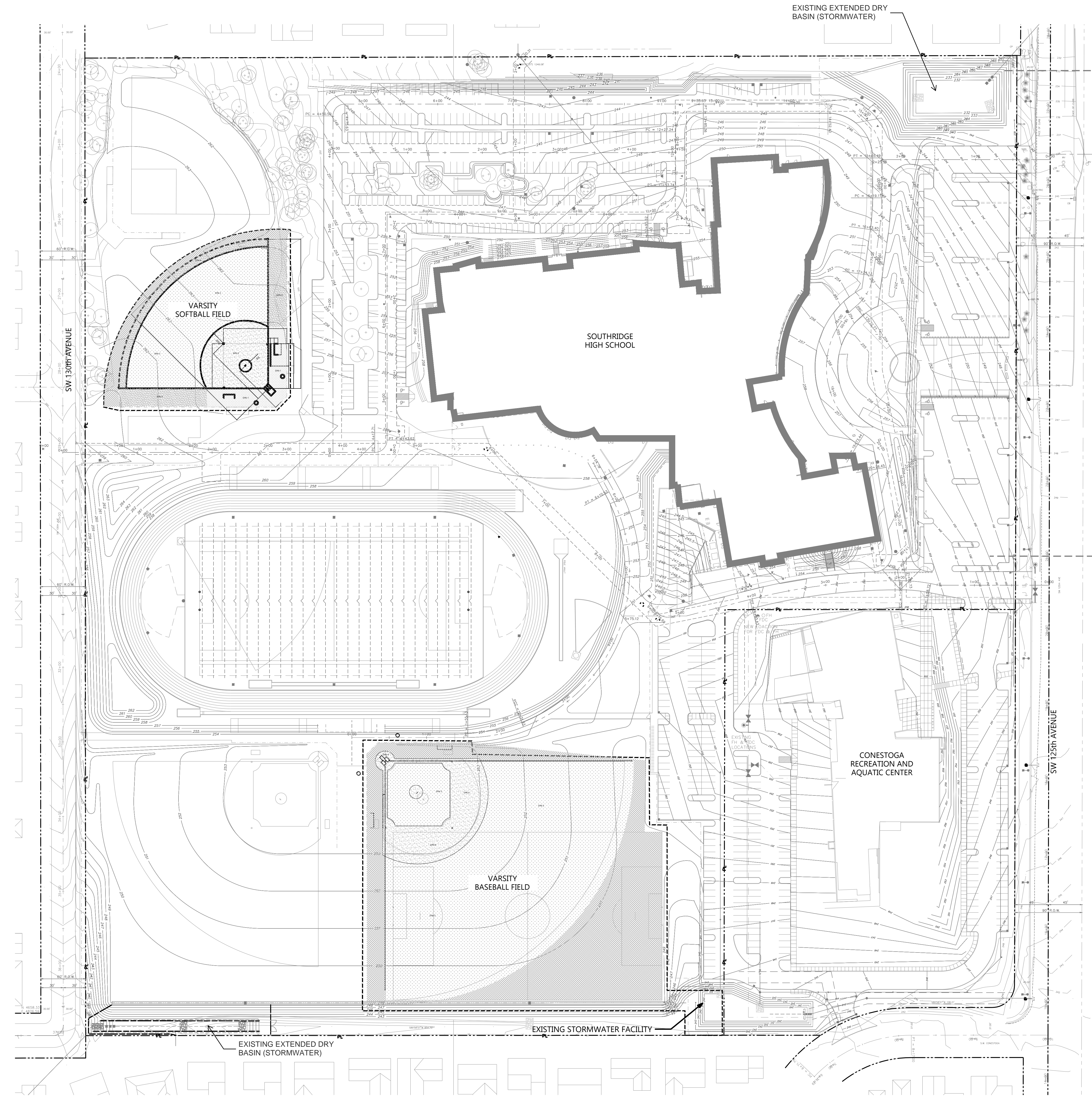

LEGEND

--- PROPERTY LINE
- - - - - LIMIT OF WORK

SITE PLAN NOTES

1. CONTOURS SHOWN ARE EXISTING, REFER TO GRADING PLAN FOR PROPOSED CONTOURS

1 OVERALL SITE PLAN
1" = 60'-0"

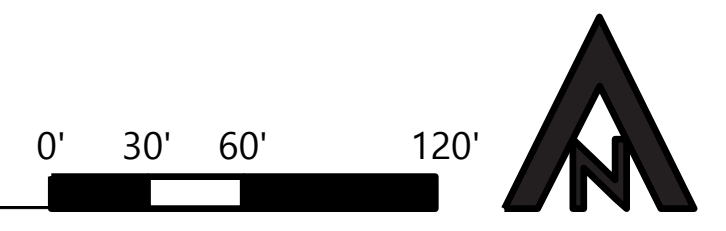

**SOUTHRIDGE HIGH SCHOOL
ATHLETIC FIELD IMPROVEMENTS**

9625 SW 125th Ave.
Beaverton, OR 97008

STAMP

**FOR
INFORMATION
ONLY**

Drawn By: JG
Checked: JG/MK
Project #: 23.004
Date: 04/28/2023

Rev. #	Date
#	dd/mm/yy

50%
PRELIMINARY
DESIGN





SHEET TITLE

**SOFTBALL
SITE PLAN**

SHEET #

L1.1

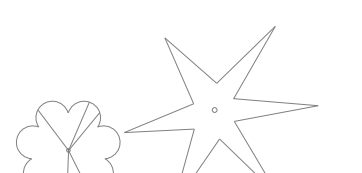
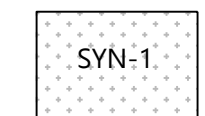
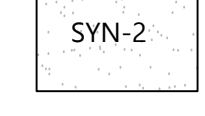
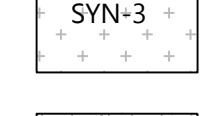
LEGEND

-  PROPERTY LINE
-  LIMIT OF WORK
-  EXISTING TREES
To Remain
-  SYNTHETIC TURF - TYPE 1
-  SYNTHETIC TURF - TYPE 2
-  SYNTHETIC TURF - TYPE 3
-  SYNTHETIC TURF - TYPE 4
-  LAWN REPAIR

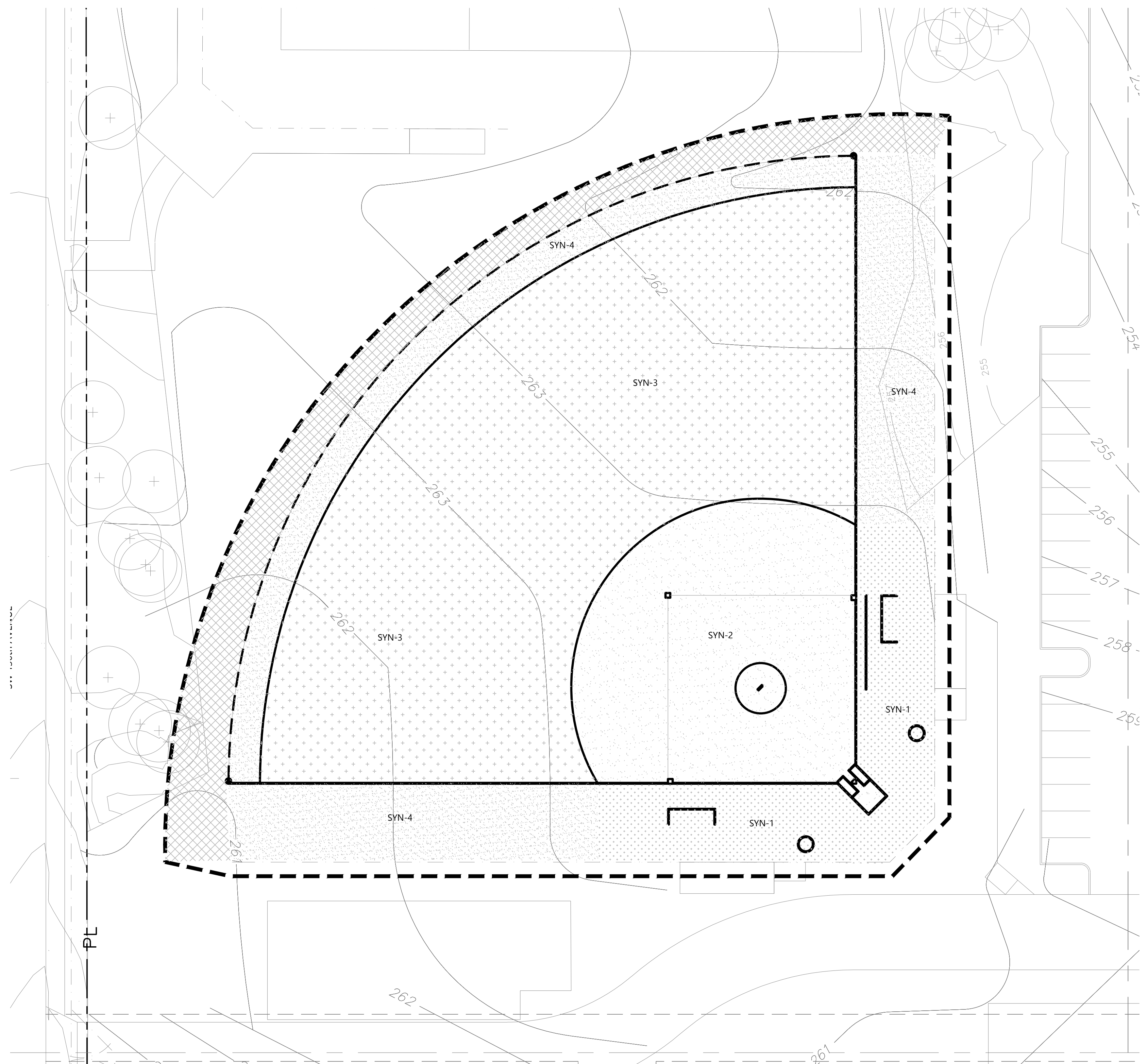

1 SOFTBALL SITE PLAN
1" = 20'-0"

0' 10' 20' 40'



**SOUTHRIDGE HIGH SCHOOL
ATHLETIC FIELD IMPROVEMENTS**
9625 SW 125th Ave.
Beaverton, OR 97008

STAMP
FOR INFORMATION ONLY

Drawn By: JG
Checked: JG/MK
Project #: 23.004
Date: 04/28/2023



Rev. #	Date
#	dd/mm/yy

50% PRELIMINARY DESIGN

SHEET TITLE
BASEBALL SITE PLAN

SHEET #
L1.2

LEGEND

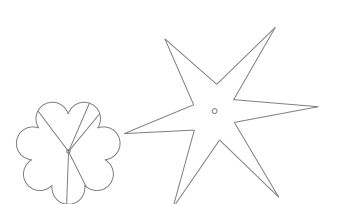
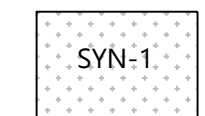
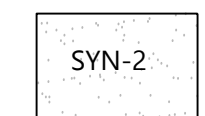
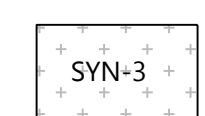
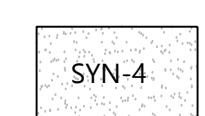
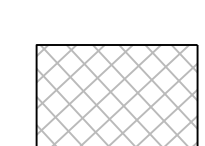
-  PROPERTY LINE
-  LIMIT OF WORK
-  EXISTING TREES To Remain
-  SYNTHETIC TURF - TYPE 1
-  SYNTHETIC TURF - TYPE 2
-  SYNTHETIC TURF - TYPE 3
-  SYNTHETIC TURF - TYPE 4
-  LAWN REPAIR

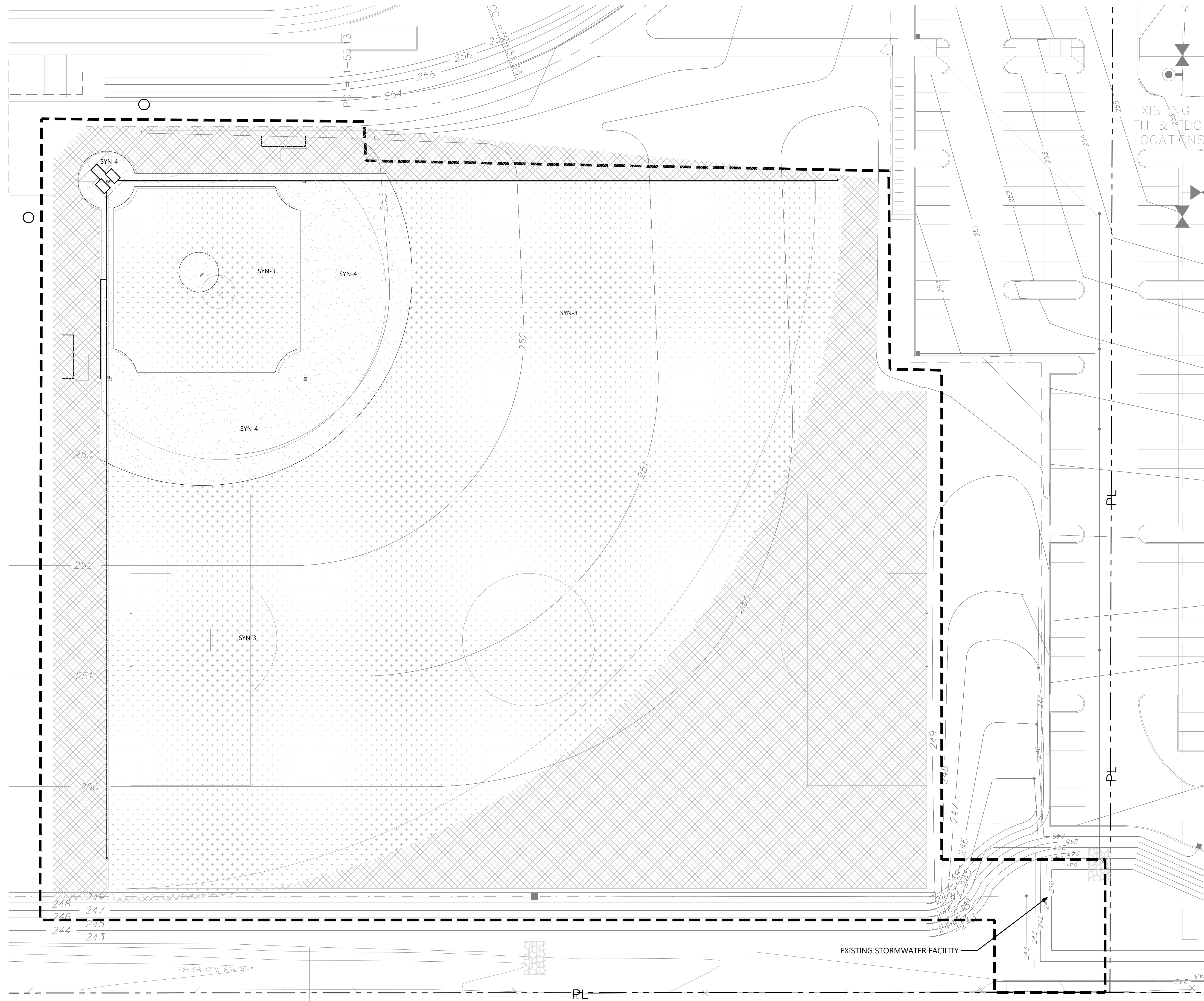

1 BASEBALL SITE PLAN
1" = 20'-0"

0' 10' 20' 40'



SITE PLAN NOTES

- See Sheet L1.0 for Site Plan notes.